

PIVOT ASSEMBLY, HORIZONTAL TO VERTICAL IN-LINE SPLICE (SINGLE)

Modified:03/10/2011

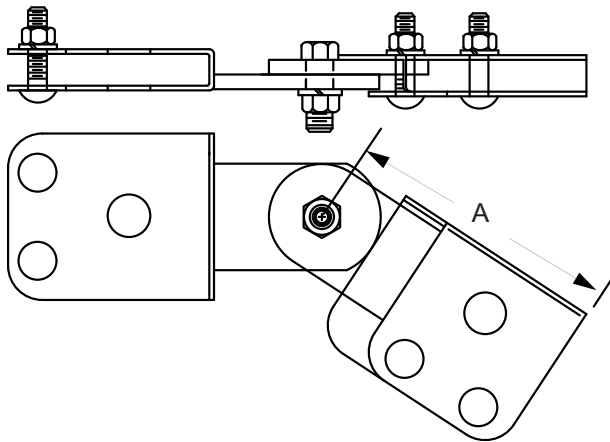

	part number	sidebar	A
Ordering	2073790010	1-1/2"	1-3/8"
	2073790110	2"	1-7/16"

	Item	Qty	Description
Stock List	1	1	clamp assembly
	2	1	clamp assembly
	3	4	carriage bolt
	4	4	1/4 lock washer
	5	4	1/4"-20 hex nut
	6	1	3/8"-16 hhcs
	7	1	3/8"-16 hex nut
	8	1	3/8" lock washer

Notes:

- Finish is zinc plated and gold chromate.
- Order qty 2 for connection of 2 cable racks.
- adjustable up to 180°