

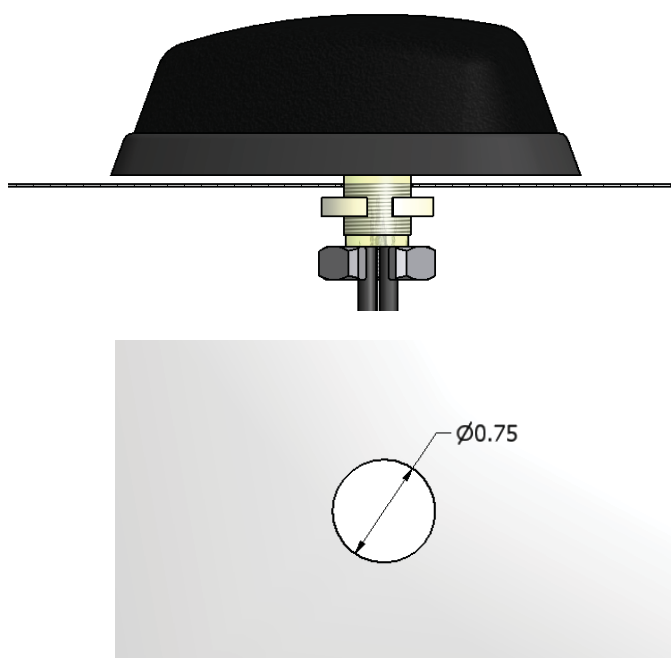

STUD MOUNT (TYPICAL INSTALLATION)

1. DETERMINE MOBILE ANTENNA/MOUNT INSTALLATION LOCATION. ENSURE THAT THE MOUNTING SURFACE IS AS FLAT AS POSSIBLE. 1.0 INCH DEEP BY 1.5 INCH DIAMETER MINIMUM IS REQUIRED BELOW MOUNTING SURFACE TO ALLOW FOR SUFFICIENT CLEARANCE FOR THE MOUNTING STUD, HARDWARE AND CABLES.
2. CUT/DRILL HOLES THROUGH MOUNTING SURFACE SIZED AND POSITIONED AS SHOWN IN DETAIL ABOVE.
3. CLEAN MOUNTING SURFACE AND BOTTOM OF MOBILE ANTENNA.
4. FEED CABLES THROUGH HOLE AND ROUTE TO DESIRED LOCATION.
5. POSITION MOBILE ANTENNA ONTO MOUNTING SURFACE. MOUNTING STUD SHALL BE LOCATED IN THE HOLE.
6. ON BOTTOM SIDE OF MOUNTING SURFACE SLIDE SLOTTED NUT AROUND CABLES AND ASSEMBLE TO MOUNTING STUD. TIGHTEN UNTIL THE RUBBER PART ON BASE OF MOBILE ANTENNA IS COMPRESSED.



471 Brighton Drive
Bloomington, IL 60108 USA
Phone: +1.630.372.6800
<http://www.antenna.com>

MIS-MEDALLION 11/09 REV. B

