

END CLOSING BAR

Modified:01/23/2017

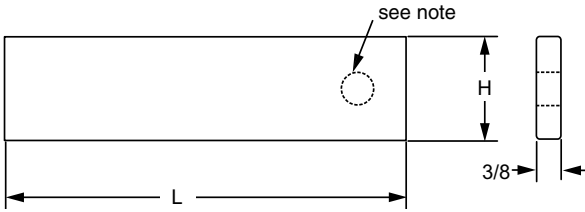

Notes:

- XX = finish code; standard finish, XX = 30.
- Bar may contain end hole(s) depending on length and finish.
- Use 002014xxxx hardware when mounting or assembling to cable rack.

	1-1/2"	2"	CR width	L
Ordering Table	00208501xx	00208515xx	5"	4-3/4"
	00208502xx	00208516xx	6"	5-3/4"
	00208503xx	00208517xx	9"	8-3/4"
	00208504xx	00208518xx	10"	9-3/4"
	00208505xx	00208519xx	11"	10-3/4"
	00208506xx	00208520xx	12"	11-3/4"
	00208507xx	00208521xx	15"	14-3/4"
	00208508xx	00208522xx	18"	17-3/4"
	00208509xx	00208523xx	20"	19-3/4"
	00208510xx	00208524xx	21"	20-3/4"
	00208511xx	00208525xx	24"	23-3/4"
	00208512xx	00208526xx	25"	24-3/4"
	00208513xx	00208527xx	27"	26-3/4"
	00208514xx	00208528xx	30"	29-3/4"
	20237920xx	20166325xx	36"	35-3/4"