

NOTES: UNLESS OTHERWISE SPECIFIED  
1. INTERPRET DRAWING PER ANSI/ASME Y14.5

2. MATERIALS:  
RADOME: ASA, LIGHT GREY  
BACK PLATE: ALUMINUM  
CABLE: RG-58/U HIGH PERFORMANCE, PLENUM RATED  
CONNECTOR:

BODY: GOLD PLATED BRASS  
CONTACT: GOLD PLATED BE CU  
GASKET: SILICONE

MOUNT: NICKEL ZINC TRIVALENT COATED STEEL

3. ALL MATERIALS SHALL BE ROHS COMPLIANT.

4. PARTS SHALL BE PACKAGED TO PREVENT DAMAGE IN SHIPMENT AND HANDLING.

5. AN [X] DIM IDENTIFIES A KEY CHARACTERISTIC AND MAY REQUIRE Cpk STUDY AS OUTLINED IN

PCTEL COR. A COMPLETE 1ST ARTICLE LAYOUT SHALL BE SUBMITTED WITH INITIAL ORDER.

A (REF) DIMENSION IS FOR INFORMATION PURPOSES ONLY AND NO TOLERANCE IS IMPLIED.

6. SUPPLIER SHALL REVIEW AND COMPLETE AND SIGN SUPPLIER INPUT/ PRINT ACCEPTANCE BLOCK.

7. PIPE RANGE: 1"-2" SCHEDULE 40 (MAX 2.375")

TILT RANGE: 0-70 DEGREES

MAX DOWN TILT/UP TILT DEPENDS ON PIPE SIZE

8. ELECTRICAL SPECIFICATION: VSWR

2.4-2.5GHz <2:1

5.15-5.85GHz <2:1

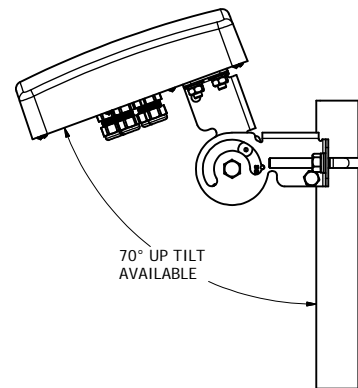
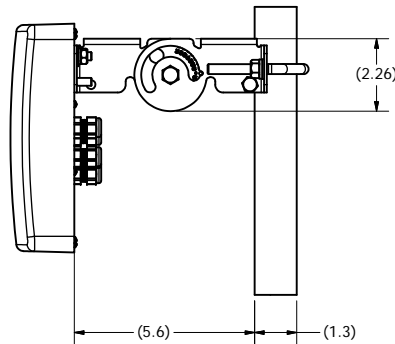
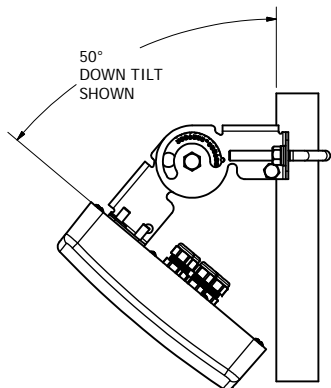
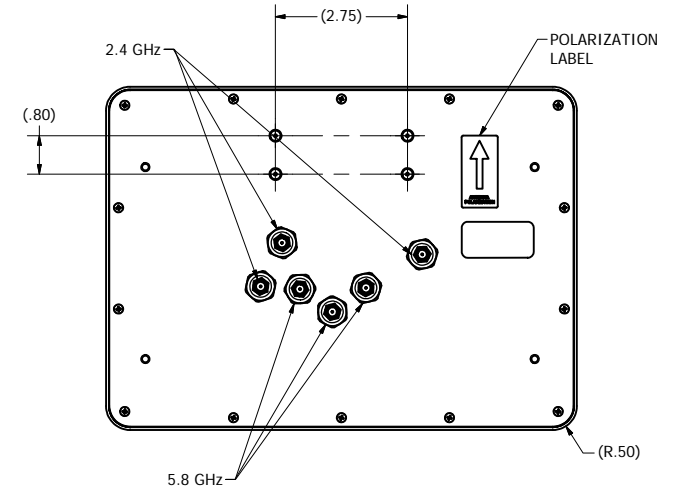
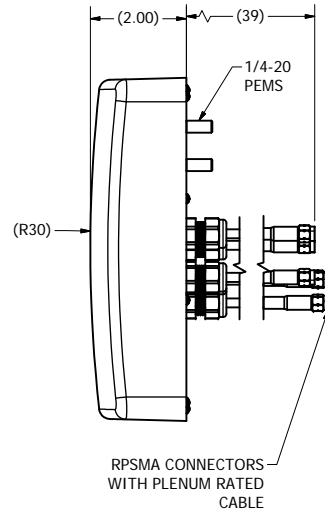
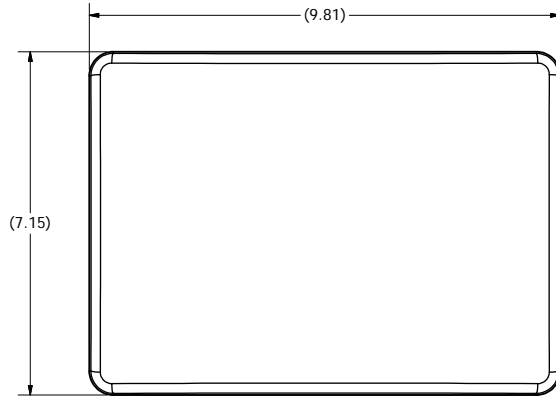

SUPPLIER PRINT ACCEPTANCE:		UNLESS OTHERWISE SPECIFIED DIMENSIONS ARE IN INCHES		DRAWN JMP 9/10/2013		DATE	
[ ] Accept drawing/specification: No changes needed: [ ] This part is RoHS compliant [ ] This part is REACH compliant [ ] Accept drawing/specification. Notes/Mark-ups added [ ] Cannot accept drawing/spec. Notes/Mark-ups added Supplier Projected Outgoing Quality:		FOR TOLERANCES NOT SPECIFIED USE: X.XX in ± .1 in, X.XX in ± .01 in, X.XXX in ± .005 in ANGULAR: 1°, FRACTIONAL ± 1/64		CHECKED		DATE	
SIGMA LEVEL: _____ or PPM: _____		THIRD ANGLE PROJECTION		MATERIAL: SEE COMPONENT PRINTS		FINISH: SEE COMPONENT PRINTS	
Signature: _____ Date: _____		PCTEL PROPRIETARY DATA THE INFORMATION AND/OR DRAWINGS CONTAINED IN THIS DOCUMENT IS CONFIDENTIAL AND PROPRIETARY TO PCTEL, INC. AND MAY NOT BE USED, REPRODUCED, IN WHOLE OR IN PART, OR MODIFIED IN ANY WAY WITHOUT THE EXPRESS WRITTEN PERMISSION OF AN AUTHORIZED REPRESENTATIVE OF PCTEL, INC.		PCTEL, INC. 471 BRIGHTON DRIVE BLOOMINGDALE, IL 60108 PH. 630-372-6800 FAX. 630-372-8077		DESCRIPTION ANTENNA, DIRECTIONAL, MIMO, 2.4 & 5.8 GHz, RPSMA	
SIZE C		SCALE NA		SHEET 1 OF 1		DRAWING NO. ODD_FPMI2458-VP6RPSMA	