

NOTES: (UNLESS OTHERWISE SPECIFIED)

1. DIMENSIONS ARE IN INCHES [CENTIMETERS]
2. DIMENSIONS ARE FOR REFERENCE ONLY

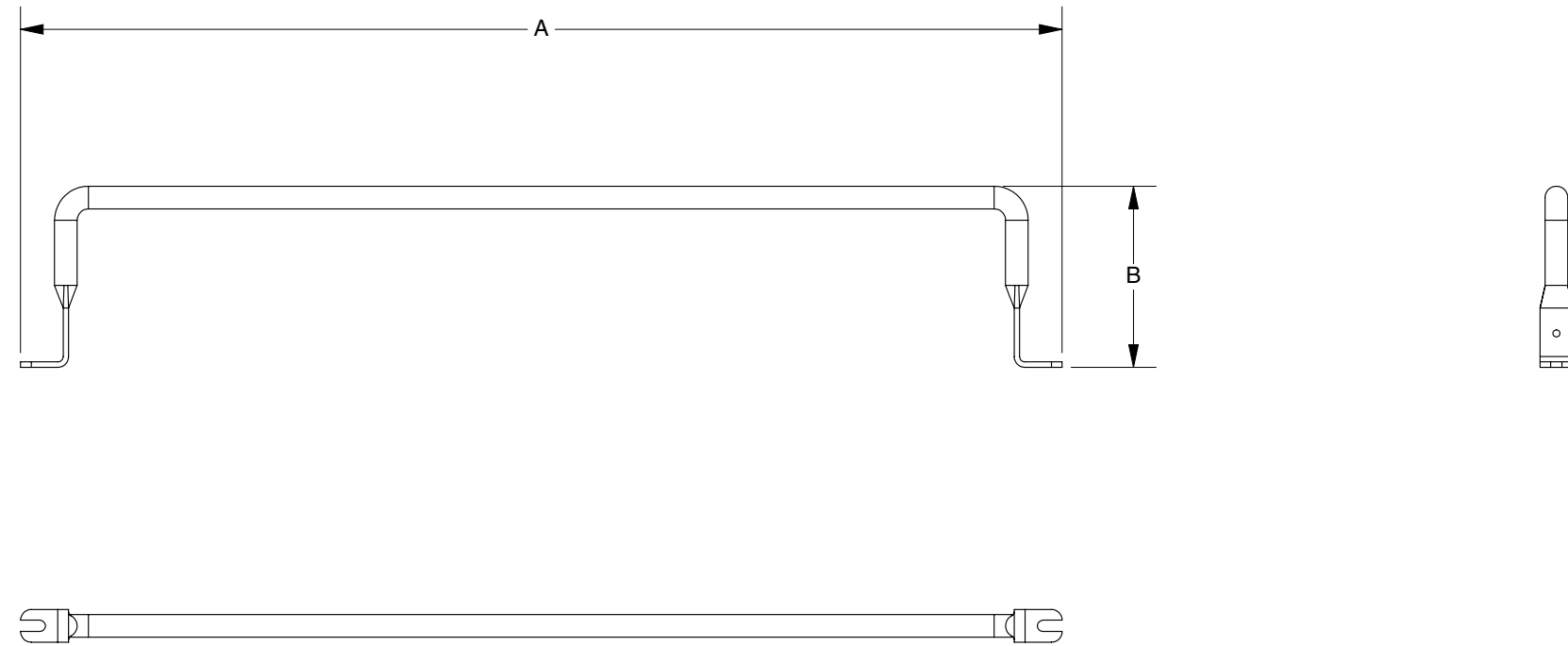

A3		FIXED THE REVISION	7/28/2017	AMG
A2		UPDATED SHEET FORMATTING AND REMOVED EOL PARTS	07/05/2016	BWK
A2		ADD -22	09/10/2010	SWE
A2		ADD -14 AND -15 TO TABLE	05/15/2008	MS
A2		ADD -77 TO TABLE	04/28/2008	MS
REV	ECO	DESCRIPTION	DATE	BY

PART NUMBER	DIM "A"	DIM "B"
37615-01	23.00 [58.42]	4.00 [10.16]
37615-02	19.00 [48.26]	4.00 [10.16]
37165-07	23.00 [58.42]	5.00 [12.70]
37165-08	19.00 [48.26]	5.00 [12.70]
37165-41	19.00 [48.26]	8.00 [20.32]
37165-42	23.00 [58.42]	8.00 [20.32]
37165-77	23.00 [58.42]	10.00 [25.40]

drawing no <b>37615-01</b>	fabrication drawing TIE DOWN BAR 23" MOUNT, 4" DEEP	rev A3	units inch	designed by LYN	date 3/1/1996	tolerances (unless otherwise specified) .X ±.060 hole size: ±.005 .XX ±.020 angularity: ±1° .XXX ±.010	sheet 1 of 1	sheet size B	scale NTS	project	projection 		<b>Amphenol Telect</b>
				drawn by D. RHIMER	date 12/16/2005								